

- 1** How many Miniveyors do I need? - Allow one unit every 2.7 metres (9 feet) with a 30cm (12 inch) overlap
 How many Control Boxes do I need? - Each 3.5kVA / 3.0kW Control Box / Slave Box will power:

Power	3M40C-1HP	3M52C-1HP
110V	3	2
230V	4	3
400-500V 3 Phase	11	11

How much power do I need? - One 3.5kVA / 3kW transformer or generator per Control Box or Slave Box
 REMEMBER - The extension cable should not be more than 50 metres (150 feet) long and not less than 2.5mm² cable

- 8** Clean down after use, preferably with a high pressure washer.
 110 Volt Miniveyors can be easily cleaned whilst the units are running. 230 Volt and 3 Phase Miniveyors can only be cleaned with the power supply disconnected for safety reasons.

- 2** Side extensions and hoppers can be used to reduce spillage anywhere along the system.
 For more information on our range of hoppers and side extensions, including Custom Engineered For more information contact Rako Sales.

- 3** Miniveyors with cleated belts should be used for angles of inclination above 20 / 30 degrees. The maximum angle of inclination depends on many factors - if there is any doubt, do a trial run first.

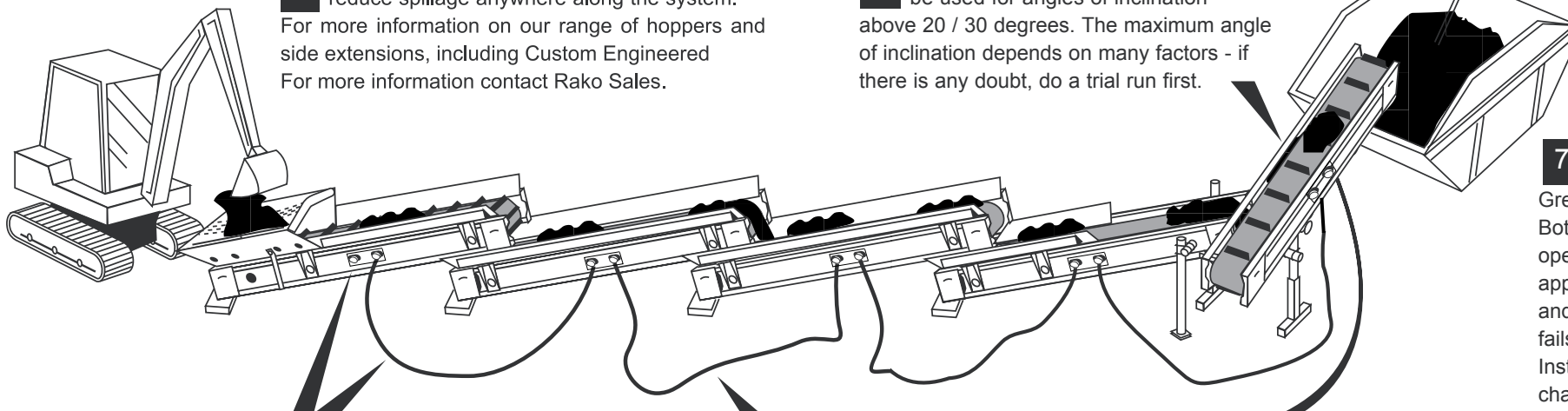

- 4** Connect the cables as shown. Interchanging plugs on a Miniveyor will change the belt direction. Always set up Miniveyor so the motor is at the discharge end. The motor end is the heavy end !

* Don't forget the terminator plug in the last empty socket, it won't work without it !

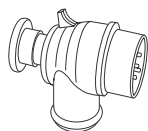

- 5** Setting up a Miniveyor is simple; just place the next Miniveyor in position so that the material from the first falls onto the next Miniveyor belt. An overlap of approximately 30 cm (12 inch) is usually required. Do not allow Miniveyor belts to rub on the ground. Support them, with blocks or pieces of wood for instance, don't bury them !

- 7** Red light means mains power available. Green light means "ready to go" Both lights need to be on for operation. If no green light appears, check sockets, cables and terminator plug. If all else fails read the Operating Instructions and the fault finding chart.

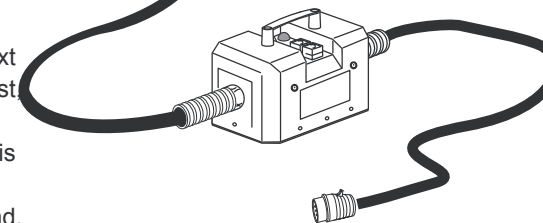

- 6** Power supply -110V, 230V or 3 Phase depending on the Miniveyor version..

Miniveyor™ ACCESSORIES

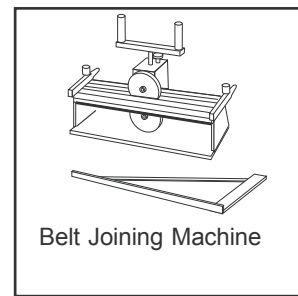
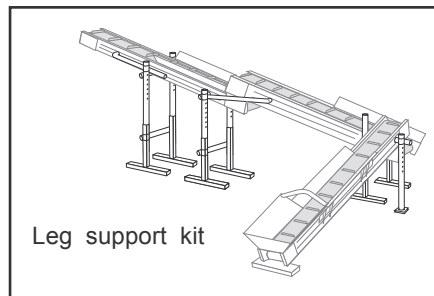
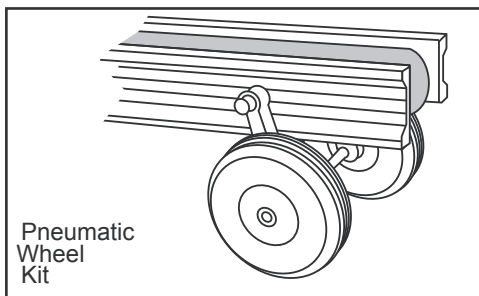
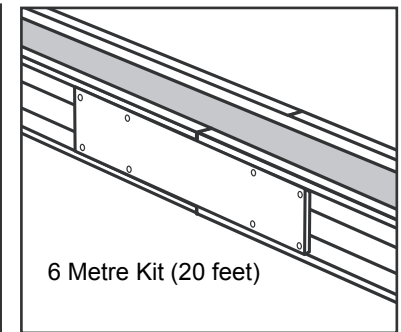
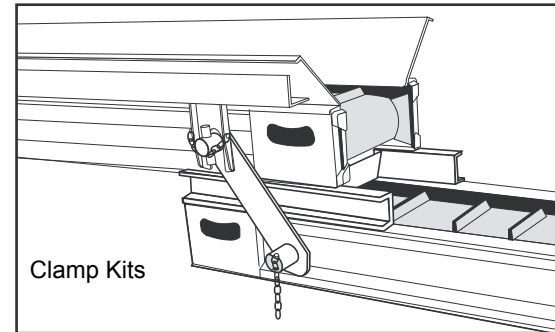
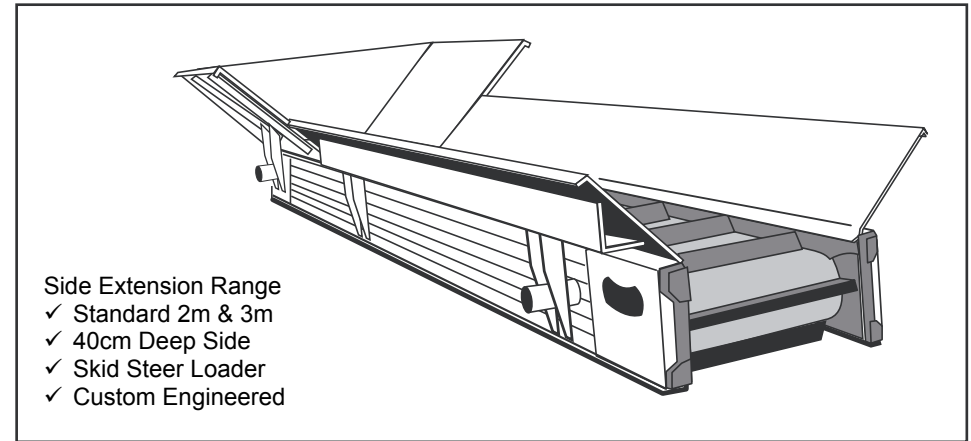
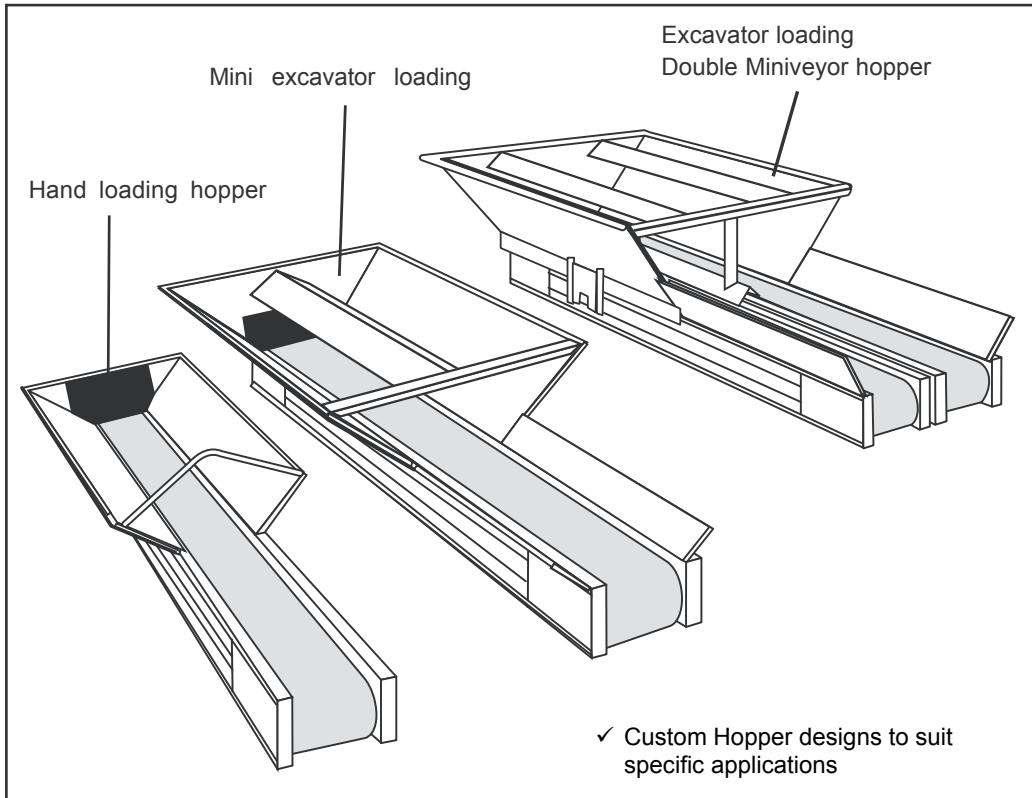

RAKO
PRODUCTS LIMITED

For information on these and other
Accessories including Custom Engineered
email - sales@rako.co.uk